

Nostalgic Art, Berlin, Germany
Architecture: Reimer & Körte (historical), Jens Beige (conversion)
Office concept: Hellmich GmbH and Büro der Sinne

Nostalgic Art Merchandising GmbH
In der Kanonenhalle
Am Borsigturm 156
Berlin
Germany

Completed: 2009

Products:
invitation, silent rush,
activation, roxy,
crossline



In the Kanonenhalle on the former Borsig site, Nostalgic Art built its company headquarters inside an outstanding specimen of old industrial architecture. Where steam locomotives used to be manufactured, nostalgic advertising articles such as metal signs in retro look are now sold.

At the new location in the north of Berlin, an area of 3,500 m² with a clear height of nine metres together with storage spaces also accommodates the company's offices in the building, whose renovation was complex and costly.



Nostalgic Art, Berlin, Germany
Architecture: Reimer & Körte (historical), Jens Beige (conversion)
Office concept: Hellmich GmbH and Büro der Sinne

Nostalgic Art Merchandising GmbH
In der Kanonenhalle
Am Borsigturm 156
Berlin

Completed: 2009

Products:
invitation, silent rush,
activation, roxy,
crossline

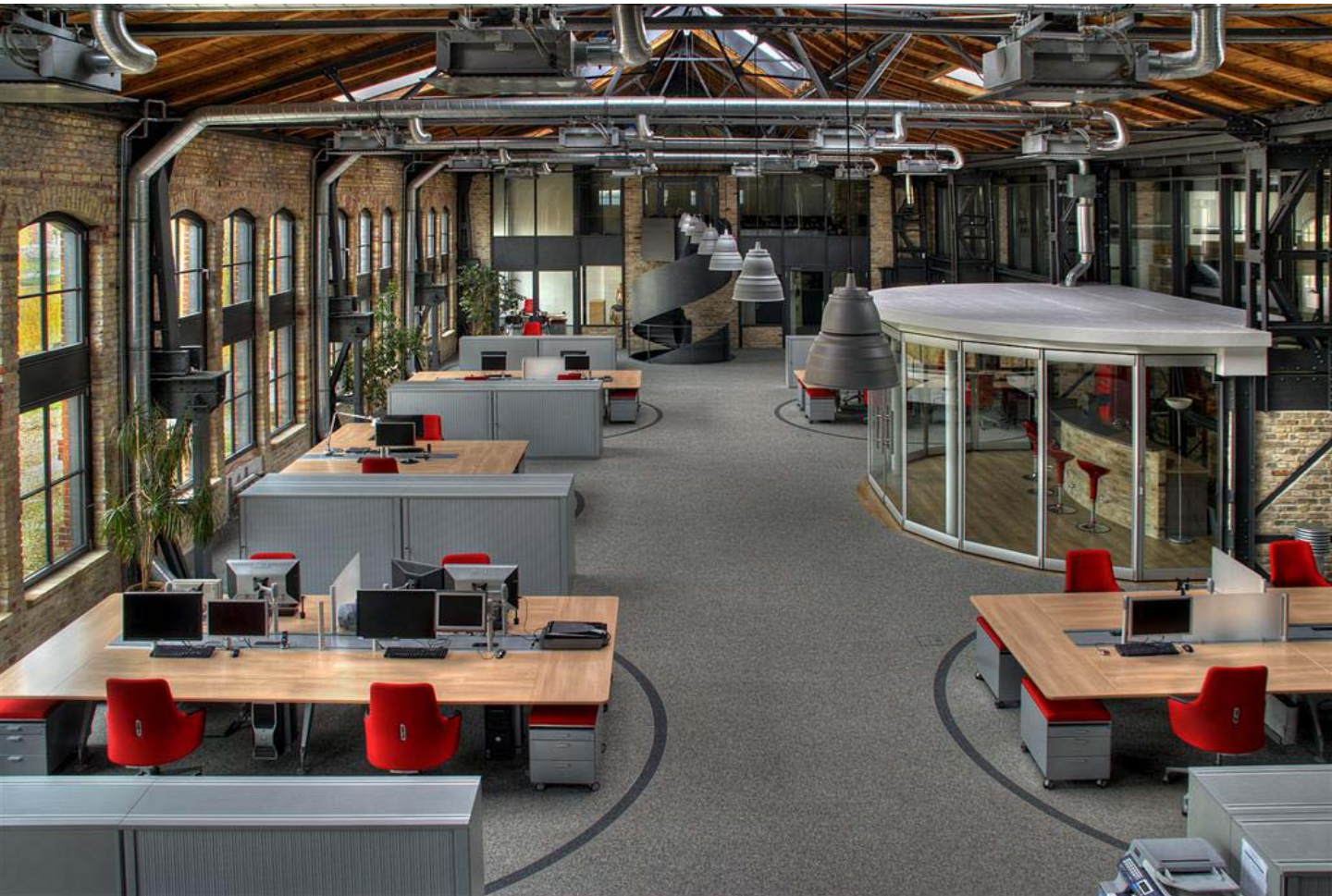

The spacious proportions and the character of the historical brickwork hall speak in favour of using the interior as an open space. The bench workstations with the **invitation** desk system and the **silent rush** office swivel chairs are segmented by means of the containers. In addition, the four-person workstations are each enclosed by a circular insert in the carpet.

For the smokers among the 20 colleagues, there is a spatially separated, air-conditioned café.

Photos: © Oliver Brettschneider



Nostalgic Art, Berlin, Germany
Architecture: Reimer & Körte (historical), Jens Beige (conversion)
Office concept: Hellmich GmbH and Büro der Sinne

Nostalgic Art Merchandising GmbH
In der Kanonenhalle
Am Borsigturm 156
Berlin

Completed: 2009

Products:
invitation, silent rush,
activation, roxy,
crossline



Part of the Kanonenhalle is used for storing articles that are ready for dispatch. Eye contact is possible between the offices and storage spaces. Everywhere, it is possible to see with just how much love for detail within a holistic approach was invested in renovating the building and fitting out its interior for its current purposes. Photos: © Oliver Brettschneider



Nostalgic Art, Berlin, Germany
Architecture: Reimer & Körte (historical), Jens Beige (conversion)
Office concept: Hellmich GmbH and Büro der Sinne

Nostalgic Art Merchandising GmbH
In der Kanonenhalle
Am Borsigturm 156
Berlin

Completed: 2009

Products:
invitation, silent rush,
activation, roxy,
crossline



In the conference rooms, the surfaces of the **invitation** tables complement the brickwork walls and the wooden ceiling. For seating, **roxy** cantilever chairs covered in black leather and **crossline** swivel conference chairs (photo below) were used which are colour-matched to the steel beams and elements. Photos: © Oliver Brettschneider

